

|              |   |                 |                      |
|--------------|---|-----------------|----------------------|
| <b>Car</b>   | CUPRA Leon 245  | <b>Part No.</b> | SSTP018              |
| <b>Year</b>  | 2021-Current  | <b>Fit Kits</b> | 003FK                |
| <b>Notes</b> | Where not supplied use original fittings. Original system requires cutting. | <b>Features</b> | Pipe Diameter:- 70mm |

Estimated Fitting Time: 1 Hour

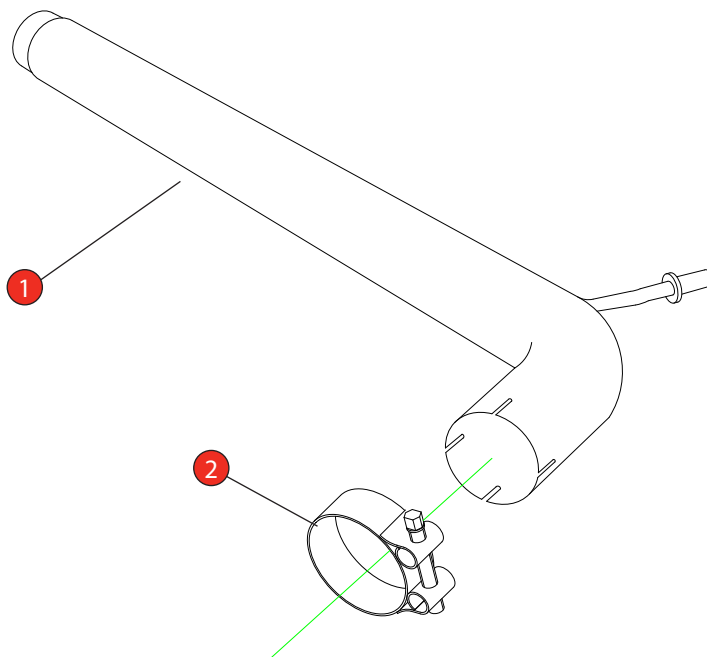

| NO.            | PART NO.   | DESCRIPTION              | QTY |
|----------------|------------|--------------------------|-----|
| 1              | 824VW      | OE Resonator Delete Pipe | 1   |
| <b>Fit Kit</b> |            |                          |     |
| 2              | Z016.10064 | 63-68mm Clamp            | 1   |

|            |            |
|------------|------------|
| DATE       | 16/11/2023 |
| ISSUE      | 00         |
| AUTHORISED | S Shipley  |

**NOTE:** ENSURE SCORPION SYSTEM IS CLEAR OF MOVING PARTS AND ALL ORIGINAL FUNCTIONS WORK CORRECTLY.



STAY CONNECTED TO RED POWER.

|              |   |                 |                      |
|--------------|---|-----------------|----------------------|
| <b>Car</b>   | CUPRA Leon 245  | <b>Part No.</b> | SSTP018              |
| <b>Year</b>  | 2021-Current  | <b>Fit Kits</b> | 003FK                |
| <b>Notes</b> | Where not supplied use original fittings. Original system requires cutting. | <b>Features</b> | Pipe Diameter:- 70mm |

Estimated Fitting Time: 1 Hour

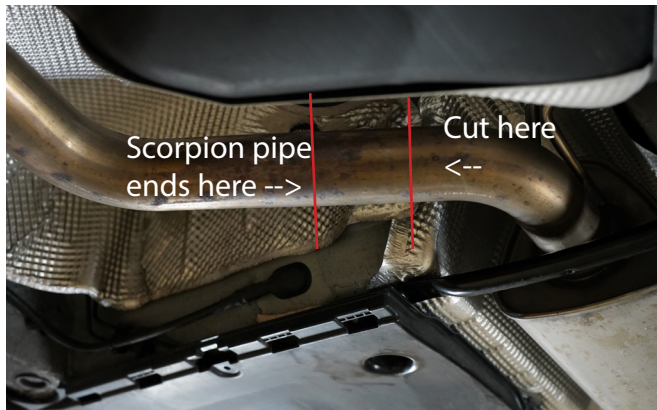

Line the resonator delete pipe up with the original exhaust and mark where the Scorpion pipe ends on the original.

Measure 70mm back from the mark you made and cut the original exhaust at this point. The Scorpion pipe will fit over the original exhaust so ensure you remove all burrs from where you've cut the pipe.

